

IGNITION COIL AND SPARK PLUG > INSTALLATION

for Preparation [Click here](#)

1. INSTALL SPARK PLUG

- a. Install the 8 spark plugs.

Torque:

21 N*m{ 214 kgf*cm , 15 ft.*lbf }

2. INSTALL IGNITION COIL ASSEMBLY

- a. Install the 8 ignition coils with the 8 bolts.

Torque:

10 N*m{ 102 kgf*cm , 7 in.*lbf }

- b. Connect the 8 ignition coil connectors.

3. CONNECT WATER PIPE AND HOSE SUB-ASSEMBLY

- a. Connect the water pipe and hose and install the 2 bolts.

Torque:

18 N*m{ 184 kgf*cm , 13 ft.*lbf }

4. INSTALL AIR CLEANER ASSEMBLY

- a. Install the air cleaner with the 3 bolts.

Torque:

5.0 N*m{ 51 kgf*cm , 44 in.*lbf }

5. INSTALL AIR CLEANER HOSE ASSEMBLY

- a. Install the air cleaner hose so that the protrusion of the air cleaner cap aligns with the groove of the hose as shown in the illustration.

Text in Illustration

*1	Groove
*2	Protrusion

- b. Tighten the 2 clamps.

Torque:

5.0 N*m{ 51 kgf*cm , 44 in.*lbf }

- c. Connect the vacuum hose.
d. Connect the No. 2 ventilation hose.

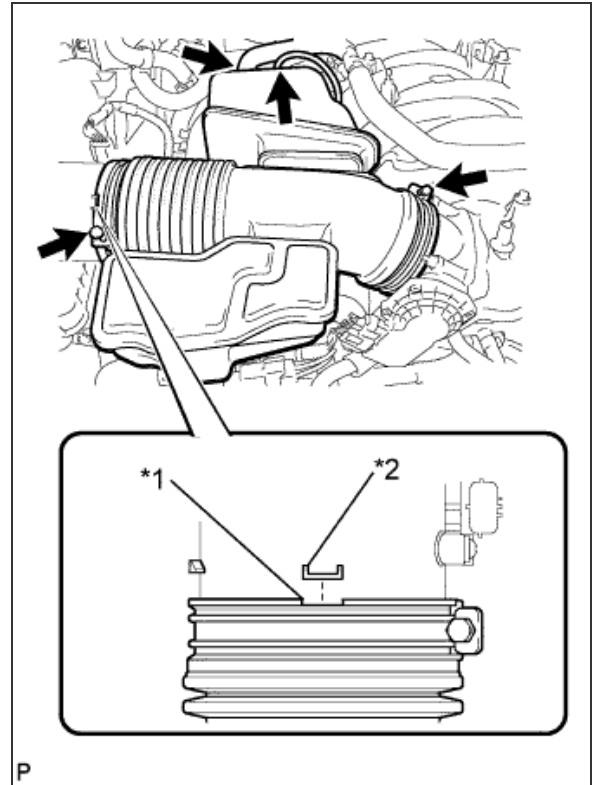

6. INSTALL V-BANK COVER SUB-ASSEMBLY

- a. Attach the 2 V-bank cover hooks to the bracket. Then align the 3 V-bank cover grommets with the 3 pins, and press down on the V-bank cover to attach the pins.

Text in Illustration

*1	Bracket
*2	Hook
*3	Pin
*4	Grommet

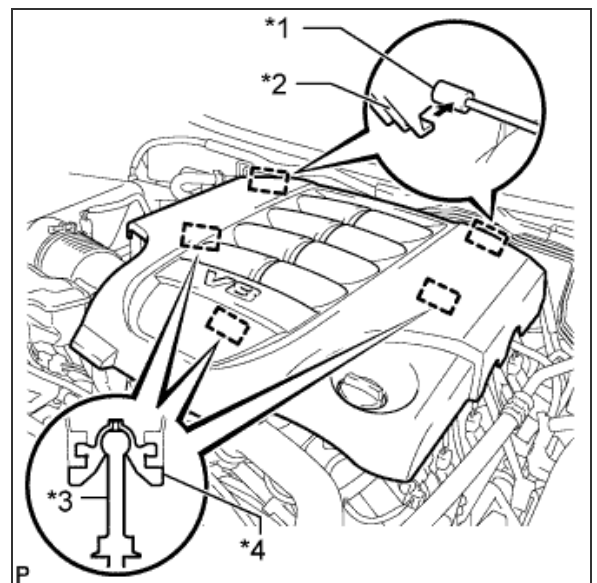

7. INSTALL NO. 2 ENGINE UNDER COVER

- a. Install the No. 2 engine under cover with the 2 bolts.

Torque:**29 N*m{ 296 kgf*cm , 21 ft.*lbf }**