

Exterior Mirrors Will Not Automatically Return When Shifting from Reverse to Drive

Service Category Vehicle Exterior

Section Mirror (ext)

Market USA

Lexus Supports
ASE Certification 

Applicability

YEAR(S)	MODEL(S)	ADDITIONAL INFORMATION
2003 – 2007	LX470	

TSIB SUPERSESSION NOTICE

The information contained in this TSIB supersedes TSIB No. EL007-06. The key changes to note are:

- 2007 model year LX 470 has been added.
- Repair Procedure now consists of 2 sections: Mirror ECU Replacement (2003 – 2007 MY) and Mirror Actuator Replacement (2003 – 2006 MY).

TSIB No. EL007-06 is Obsolete and any printed versions should be discarded. Be sure to review the entire content of this service bulletin before proceeding.

Introduction

Some 2003 – 2007 model year LX 470 vehicles may exhibit a condition where one or both of the outer rear view mirrors will not automatically return to the proper position when shifting from reverse to drive. A newly designed mirror ECU is available to correct this condition. For 2003 – 2006 model year vehicles it is also necessary to replace the mirror actuators. This condition does not affect the manual operation of the exterior mirrors from the adjustment switch.

Warranty Information

OP CODE	DESCRIPTION	MODEL YEAR	TIME	OFP	T1	T2
EL9017	R & R Remote Control Mirror ECU Assembly and R & R Actuator Assembly (Both Sides)	2003–2006	1.0	89430-60040	73	99
EL9018	R & R Remote Control Mirror ECU Assembly	2007	0.4			

Exterior Mirrors Will Not Automatically Return When Shifting from Reverse to Drive

Warranty Information (Continued)

APPLICABLE WARRANTY

- This repair is covered under the Lexus Comprehensive Warranty. This warranty is in effect for 48 months or 50,000 miles, whichever occurs first, from the vehicle's in-service date.
- Warranty application is limited to occurrence of the specified condition described in this bulletin.

Parts Information

MODEL YEAR	PREVIOUS PART NUMBER	CURRENT PART NUMBER	PART NAME	QTY
2003–2007	89430-60040	89430-60041	Computer Assy, Outer Mirror Control	1
2003–2006	87908-60840	87908-60841	Actuator Sub-Assy, Outer Mirror RH	1
	87909-60730	87909-60731	Actuator Sub-Assy, Outer Mirror LH	1

Repair Procedure: 2003 – 2007 MY Mirror ECU Replacement

1. Disconnect the negative (–) battery terminal.

CAUTION

Wait at least 90 seconds after the ignition switch is turned to the "LOCK" position and the negative (–) terminal cable is disconnected from the battery before starting the operation.

2. Remove the front door lower frame bracket garnish with a taped screwdriver.

Figure 1.

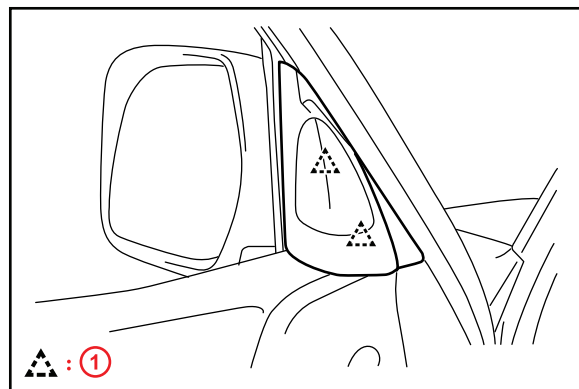

1	Clip
---	------

Exterior Mirrors Will Not Automatically Return When Shifting from Reverse to Drive

Repair Procedure: 2003 – 2007 MY Mirror ECU Replacement (Continued)

3. Remove the power window regulator master switch assembly.
 - A. Using a taped screwdriver, remove the switch as shown in the illustration.
 - B. Disconnect the connector.

Figure 2.

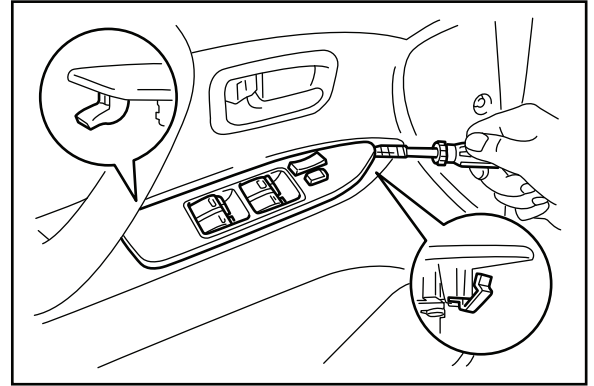

4. Remove the center speaker assembly (w/Mark Levinson).
 - A. Disconnect the connector.
 - B. Using a taped screwdriver, remove the speaker.
5. Remove the No. 2 door inside handle bezel using a taped screwdriver.

Figure 3.

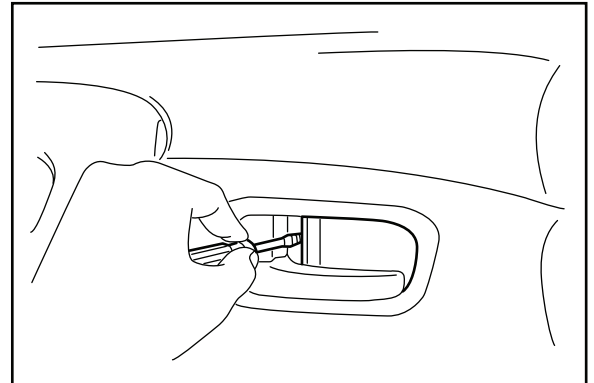

6. Remove the No. 1 door inside handle bezel.
 - A. Remove the screw.
 - B. Using a taped screwdriver, remove the bezel as shown in the illustration.

Figure 4.

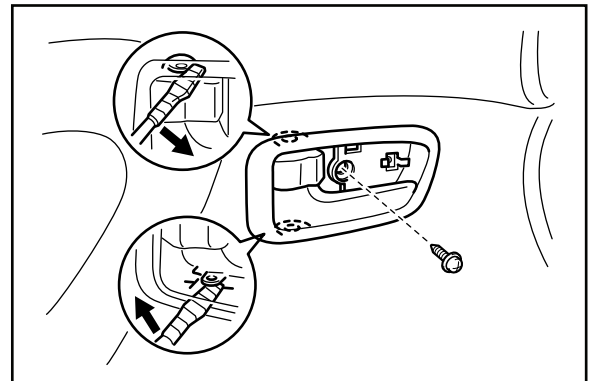

Exterior Mirrors Will Not Automatically Return When Shifting from Reverse to Drive

Repair Procedure: 2003 – 2007 MY Mirror ECU Replacement (Continued)

7. Remove the front door courtesy light with a taped screwdriver, and then disconnect the connector.

Figure 5.

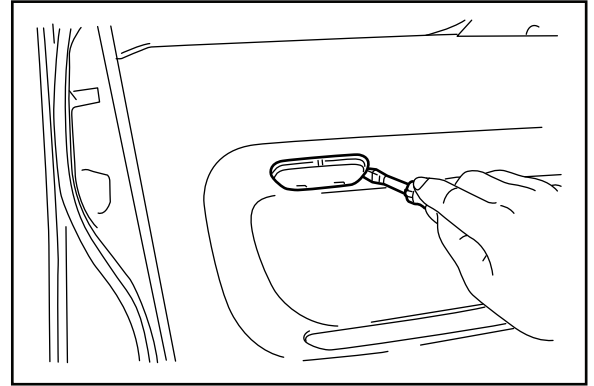

8. Remove the seat memory switch with a taped screwdriver, and then disconnect the connector.
9. Remove the front door trim board sub-assembly.

Figure 6.

- A. Remove the 2 caps and 7 screws.
- B. Remove the 3 clips.
- C. Insert a taped screwdriver between the door and door trim to pry the trim.

NOTICE

Be careful NOT to damage the door and door trim.

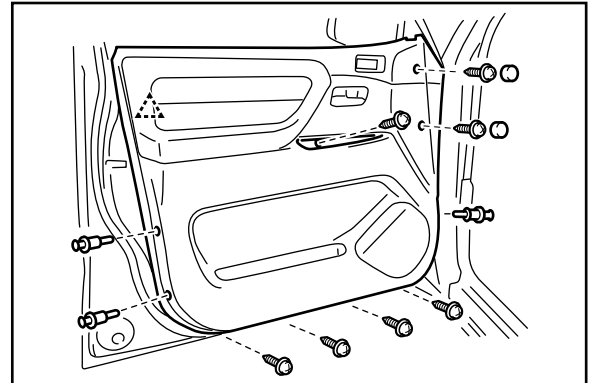

- D. Pull the trim upward to remove it.

Exterior Mirrors Will Not Automatically Return When Shifting from Reverse to Drive

Repair Procedure: 2003 – 2007 MY Mirror ECU Replacement (Continued)

10. Locate the mirror ECU and disconnect the 25 pin (R30) connector (white).

Figure 7.

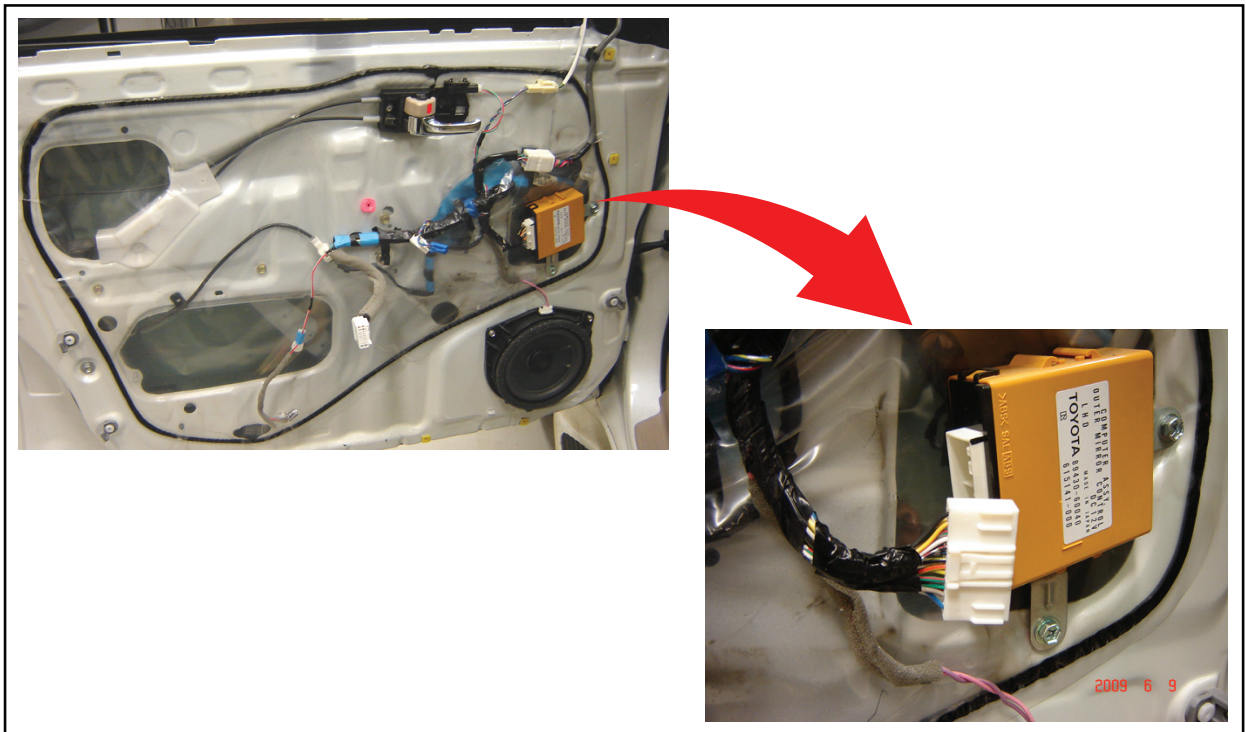

11. Remove the 2 bolts and the mirror ECU.
12. Install the NEW mirror ECU assembly.
13. Install the front door trim board sub-assembly.

- A. Attach the trim board.
- B. Install the 3 clips.
- C. Install the 7 screws and 2 caps.

Figure 8.

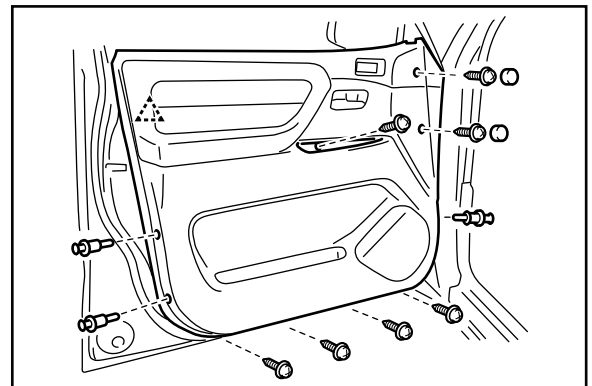

Exterior Mirrors Will Not Automatically Return When Shifting from Reverse to Drive

Repair Procedure: 2003 – 2007 MY Mirror ECU Replacement (Continued)

14. Install the seat memory switch.
 - A. Connect the connector.
 - B. Install the switch.
15. Install the front door courtesy light.
 - A. Connect the connector.
 - B. Install the light.
16. Install the No. 1 door inside handle bezel with the screw.
17. Install the No. 2 door inside handle bezel.
18. Install the center speaker assembly by connecting the connector (w/Mark Levinson).
19. Install the power window regulator master switch assembly.
 - A. Connect the connector.
 - B. Install the switch.
20. Install the front door lower frame bracket garnish. **Figure 9.**

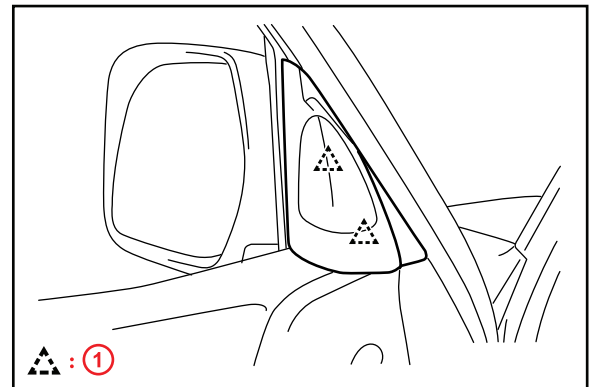

1	Clip
---	------

21. Reconnect the negative (–) battery terminal.
22. Check operation of mirrors.
23. Re-initialize affected power systems.

Refer to the applicable Technical Service Bulletin:

- 2003 – 2004 model year:

[PG011-02](#), “Initialization of VGRS System”

Exterior Mirrors Will Not Automatically Return When Shifting from Reverse to Drive

Repair Procedure: 2003 – 2007 MY Mirror ECU Replacement (Continued)

- 2005 model year:
[PD010-05](#), "Power System Initialization During PDS"
- 2006 model year:
[PD009-06](#), "Power System Initialization During PDS"
- 2007 model year:
[PD007-07](#), "Power System Initialization During PDS"

Repair Procedure: 2003 – 2006 MY Mirror Actuator Replacement

1. Disconnect the mirror.
 - A. Disconnect the negative (–) battery terminal.
 - B. To prevent damage, apply protective tape on the lower side of the mirror body.
 - C. Push the upper corner of the mirror to tilt out the lower corner.
 - D. Insert a flat blade screwdriver between the mirror holder (black) and plate pivot (white), and twist to disconnect the two (2) lower claws.

Figure 10.

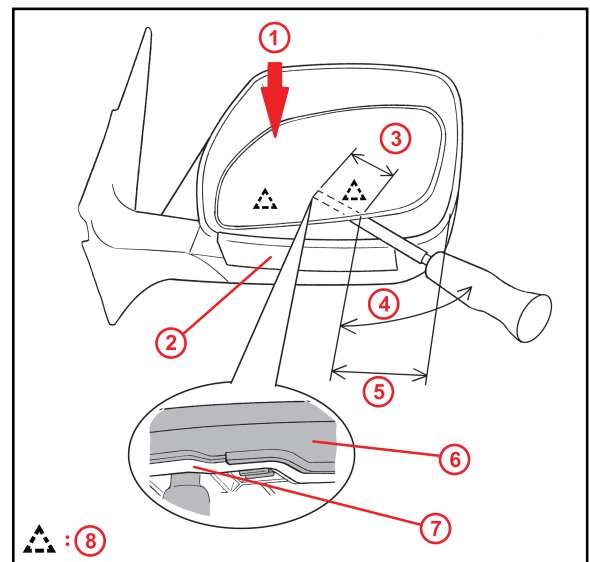

1	Push Down
2	Protective Tape
3	50 mm
4	45°
5	50 mm
6	Mirror Holder (Black)
7	Plate Pivot (White)
8	Lower Claws

Exterior Mirrors Will Not Automatically Return When Shifting from Reverse to Drive

Repair Procedure: 2003 – 2006 MY Mirror Actuator Replacement (Continued)

- E. Push the lower side of the plate pivot to tilt it down.

Figure 11.

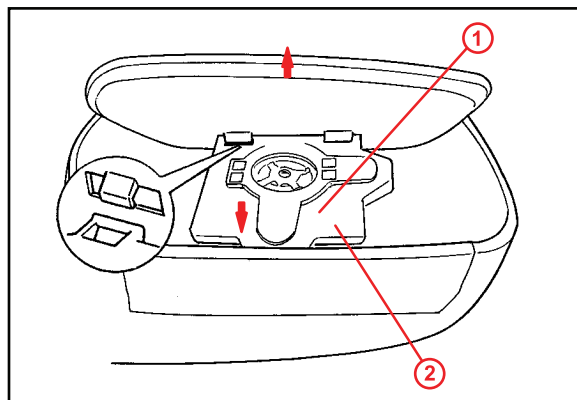

1	Push Down
2	Plate Pivot

- F. Pull up the mirror to disconnect the two (2) upper claws.

- G. For heated mirrors: Disconnect both 1-pin connectors from the mirror assembly.

Figure 12.

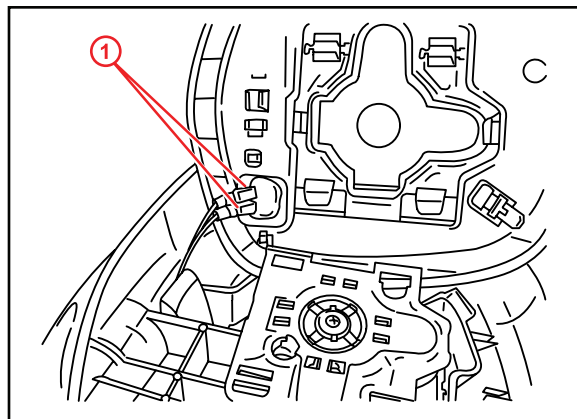

1	Heater Terminals
---	------------------

Exterior Mirrors Will Not Automatically Return When Shifting from Reverse to Drive

Repair Procedure: 2003 – 2006 MY Mirror Actuator Replacement (Continued)

2. Remove the mirror actuator.

A. Remove the three (3) screws from the actuator. **Figure 13.**

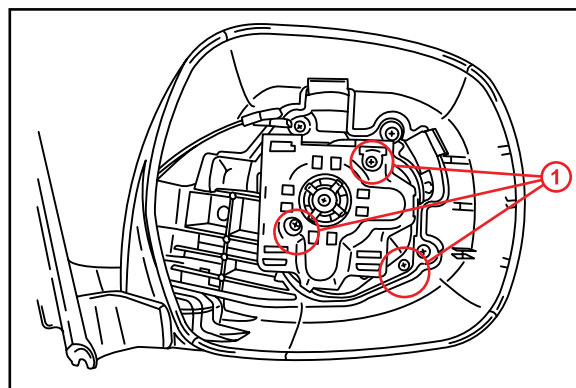

1	3 Screws
---	----------

B. Gently disconnect the three (3) connectors from the mirror actuator.

Figure 14.

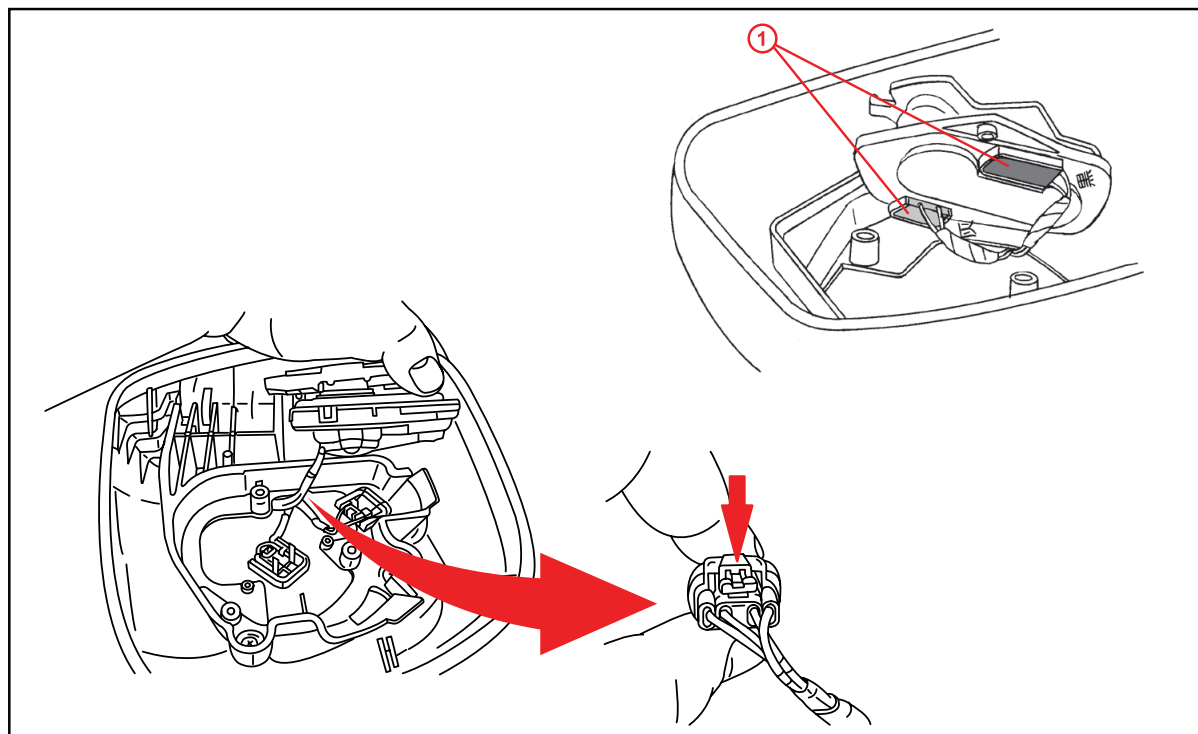

1	Connector
---	-----------

Exterior Mirrors Will Not Automatically Return When Shifting from Reverse to Drive

Repair Procedure: 2003 – 2006 MY Mirror Actuator Replacement (Continued)

NOTE

Disconnect the hidden 5-pin connector by pushing down on the lock tab.

- C. Remove the OLD actuator and discard.
3. Assemble a NEW actuator and mirror.

NOTE

- Reassembly is the reverse order of disassembly.
- You MUST fit in the harness connector correctly.

Confirm correct connector color indication on the back surface of the mirror actuator (one gray and one black flat 2-pin connector).

- A. Tighten the three (3) screws for the actuator.
Torque: 1.5 – 1.96 N*m (15.30 – 19.99 kgf*cm, 13.28 – 17.35 ft*lb)

- B. For heated mirrors: Resecure the heater terminals.

Figure 15.

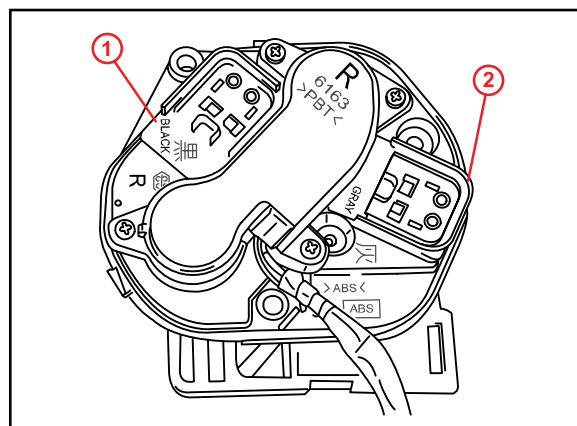

1	Black Connector
2	Gray Connector

Figure 16.

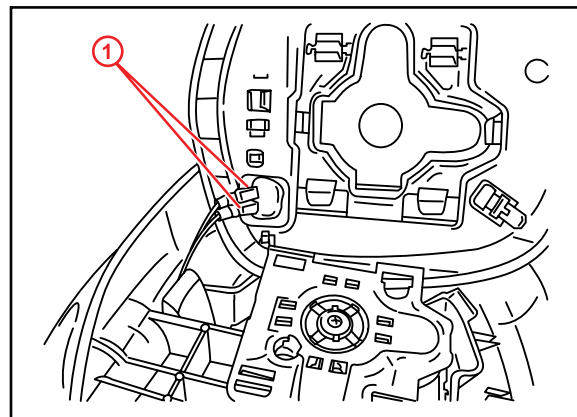

1	Heater Terminals
---	------------------

Exterior Mirrors Will Not Automatically Return When Shifting from Reverse to Drive

Repair Procedure: 2003 – 2006 MY Mirror Actuator Replacement (Continued)

- C. Hook the upper claws of the mirror holder into the plate pivot.

Figure 17.

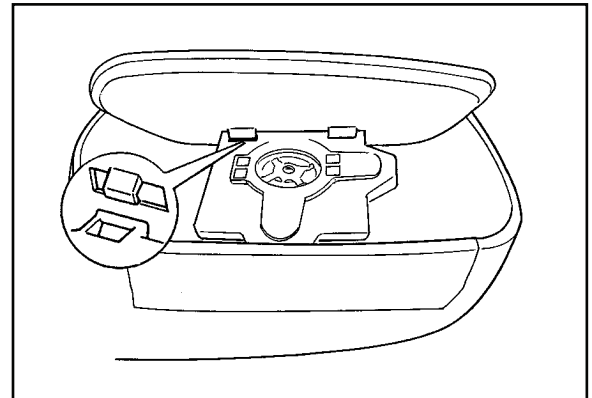

- D. Reconnect the mirror holder — Apply pressure to the indicated areas until you hear the holder clips snap into place.

Figure 18.

CAUTION

If pressure is applied in areas other than the ones indicated, the mirror glass may break.

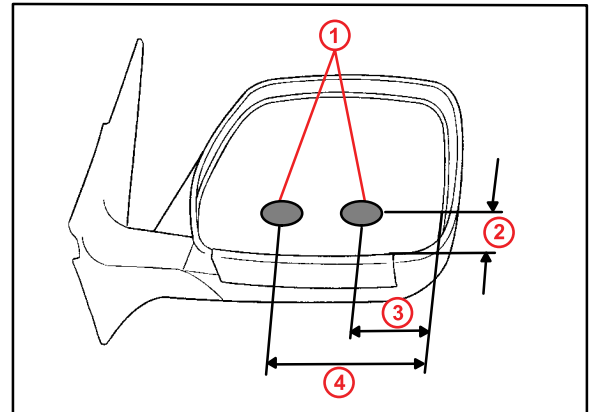

1	Push here
2	50 mm
3	70 mm
4	120 mm

- Repeat steps 1B through 3D on the opposite side rear view mirror.
- Reconnect the negative (–) battery terminal.
- Test normal operation of mirrors.
- Remove the protective tape and clean the mirror housing and glass.

Exterior Mirrors Will Not Automatically Return When Shifting from Reverse to Drive

Repair Procedure: 2003 – 2006 MY Mirror Actuator Replacement (Continued)

8. Re-initialize affected power systems.

Refer to the applicable Technical Service Bulletin:

- 2003 – 2004 model year:

[PG011-02](#), *"Initialization of VGRS System"*

- 2005 model year:

[PD010-05](#), *"Power System Initialization During PDS"*

- 2006 model year:

[PD009-06](#), *"Power System Initialization During PDS"*