

- \*Always disconnect the negative(-) terminal of the vehicle battery and drain all capacitors before installation.
- \*Protect all wire harness placed near any metal parts of the vehicle with loom or other wire protection.
- \*Always check all vehicle functions AFTER completion, such as brake lamps, turn signals.

Before starting installation, verify that the original audio system in the vehicle is fully functional. This kit will not remedy any issues that existed before the installation or faults in the original systems in the vehicle.

Thank you for purchasing Beat-Sonic USA SLA-100.

Please read carefully and follow these instructions before installing this product.

Car Model	Year	Chassis Code
Land Cruiser/ Lexus LX 470	1998-2002	GF-UZJ100W •KG-UZJ100 W•GF-HD/101K

#### Product Features

1. OEM head unit can be substituted for aftermarket head unit.

#### Note:

-This product is incompatible on vehicles with Multi-Vision Monitor Screens



製品寸法 : 40×25×85.3mm (幅/高さ/奥行) ・重量 : 約210g (本機のみ)

#### Included in the kit

Faceplate, Bracket(2) Double-sided Tape,



Mount all components in locations that will not inhibit safe driving or obstruct the motions of the various components of the vehicle function. Be cautious so as not to damage wires, piping tanks and other areas as installed in the vehicle. Avoid wet, dusty, or areas of extreme temperatures for installation.



Any damages resulting to the automobile of aftermarket audio systems as result of improper installations or careless installation procedures are not covered by any warranty, nor are we responsible for any injuries or damages resulting from the installation process. Please observe caution when performing installation.

Beat-Sonic USA  
14778 Beach Blvd. La Mirada, CA 90638  
Tel & Fax (714) 944-1085

## ① Removal of the original head unit

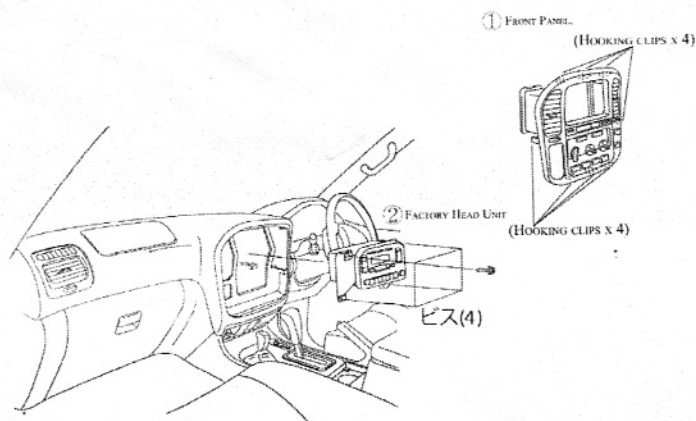

- ① REMOVE THE FRONT PANEL.
- ② REMOVE THE FACTORY HEAD UNIT.

## ② Installation of the aftermarket audio head unit

- 1 A. ATTACH THE SIDE MOUNTING BRACKETS USING THE SCREWS FROM THE AFTERMARKET HEAD UNIT.

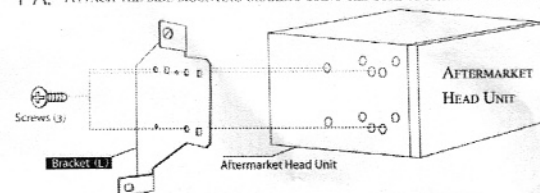

3. MOUNT NEW FACE PANEL BY USING SUPPLIED 3M AS SHOWN.

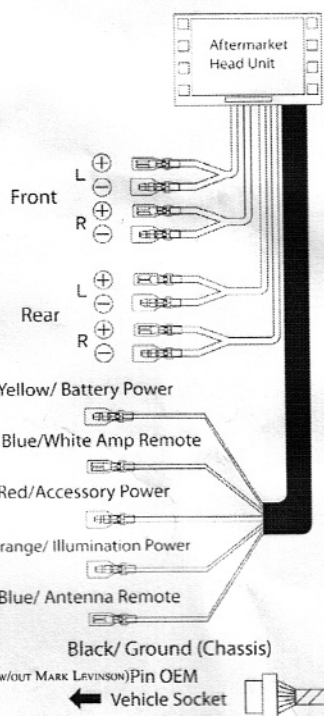
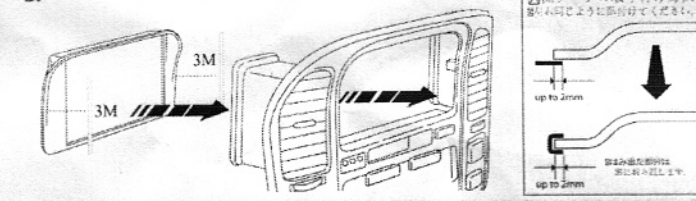

(20PINS w/ MARK LEVINSON. 22PINS w/OUT MARK LEVINSON) Pin OEM

Vehicle Socket